

Areas of relatively high densities of late 18th/19th century artifacts designated Site 67-3

P
A
S
T

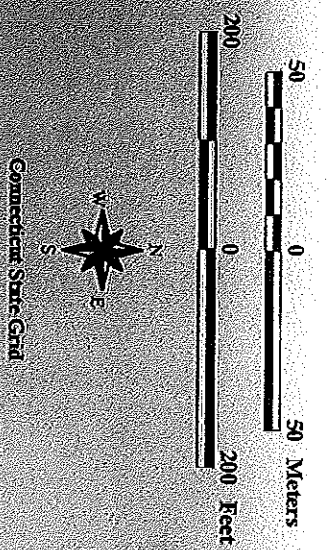

Key

□ Phase I Project Area

● Counts of Early Ceramics

● 1

● 2

● 3

● 4-5

Hebron Village Green Project
Hebron, Connecticut

Distribution of Early Period
Ceramics
(Creamware and Pearlware)

FIGURE 10

PA130007 Project: Site plan showing village green GIS Data (copy) - View Figure 6 - Layout Figure 6 (copy)

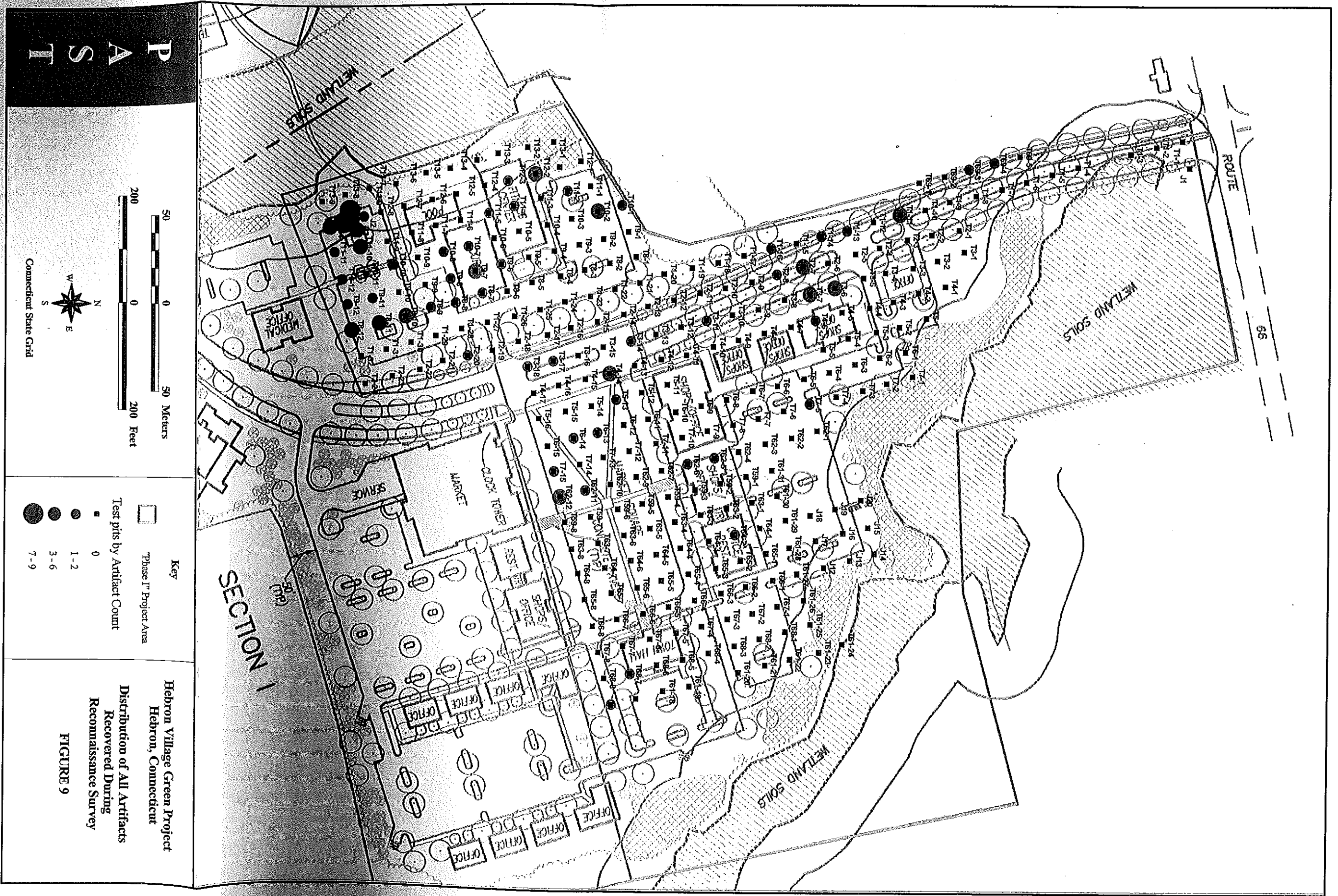

P
A
S
T

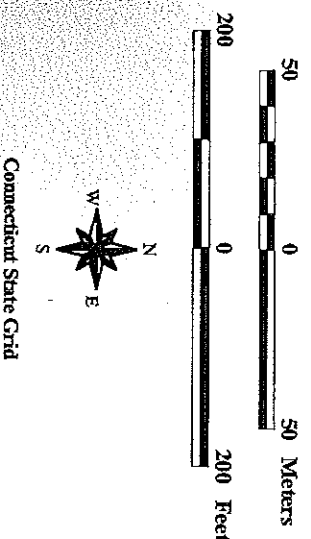

- Key**
- Phase I* Project Area
 - Test pits by Artifact Count
 - 0
 - 1-2
 - 3-6
 - 7-9

Hebron Village Green Project
Hebron, Connecticut

Distribution of All Artifacts
Recovered During
Reconnaissance Survey

FIGURE 9

2/4/2007 Project: Connecticut village green(GIS)Phase I only.apr - View figure a - Layout figure a (layout)

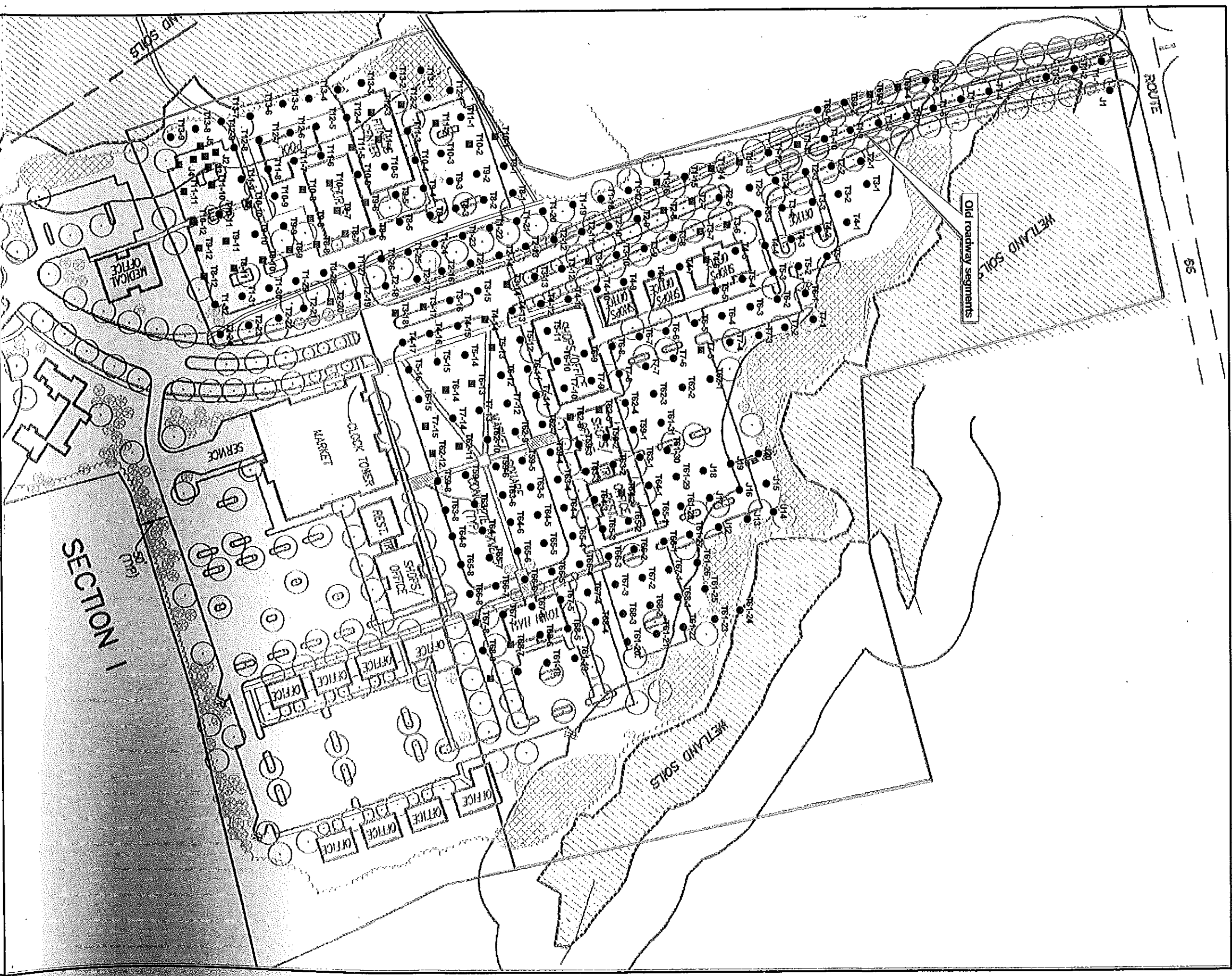

**P
A
S
T**

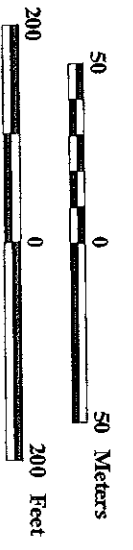

Connecticut State Grid

- Key**
- Phase I Project Area
 - Results of Archaeological Testing
 - Stenle
 - Historic Period Artifacts
 - Prehistoric Period Artifacts
 - ▬ Vestigial Roads

Hebron Village Green Project
Hebron, Connecticut

Results of Archaeological
Reconnaissance Survey

FIGURE 8

PALEO001 Project: Archaeological village green GIS Phase I only.dwg - View: Phase I - Layout: Phase I results