

64-25
Rd. Cemetery
CT

difficult to find old graves in this area
some of the old graves are in the woods
some of the old graves are in the woods
 N

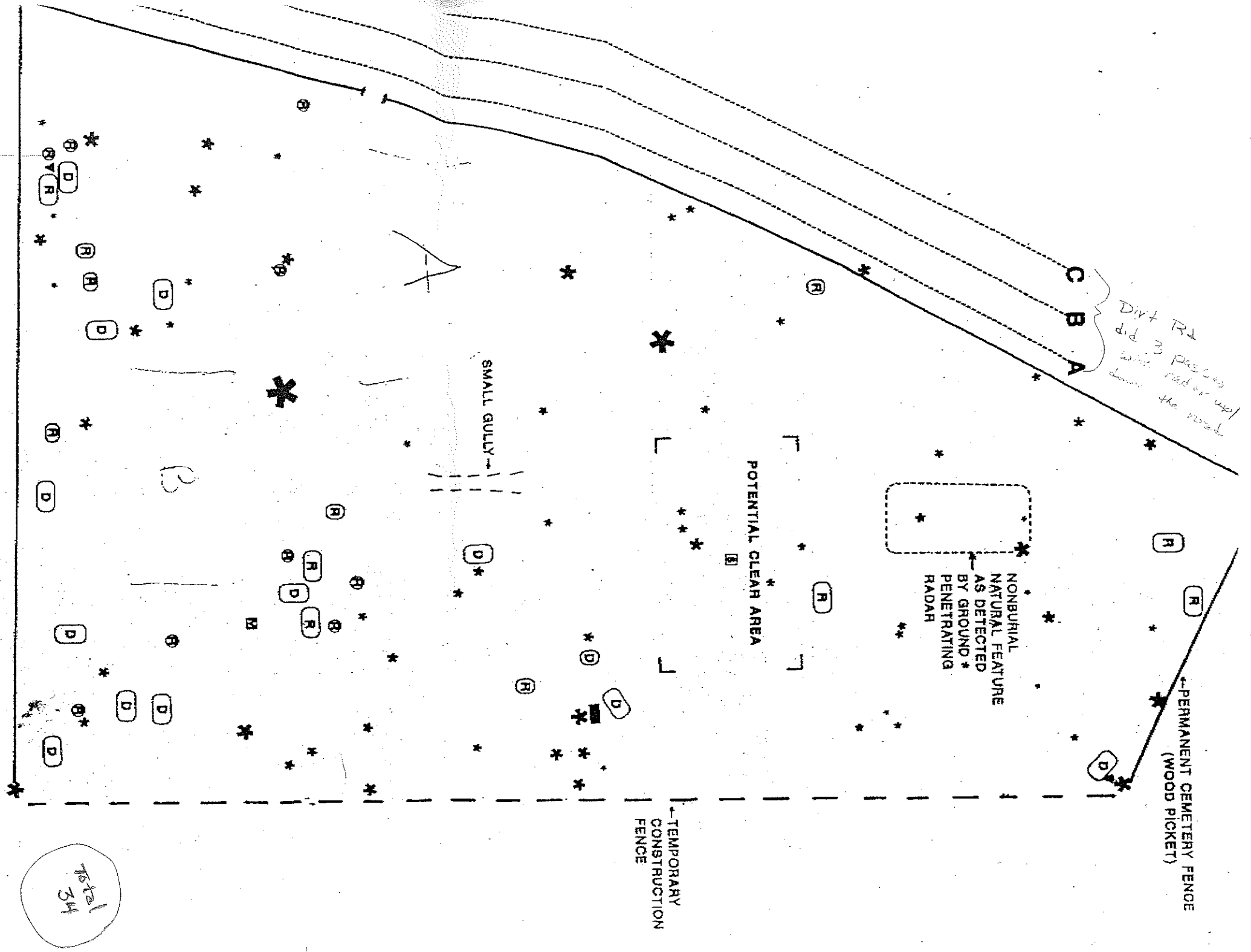

Divt Rd did 3 passes with radar up/down the road

NONBURIAL NATURAL FEATURE AS DETECTED BY GROUND PENETRATING RADAR

POTENTIAL CLEAR AREA

SMALL GULLY

PERMANENT CEMETERY FENCE (WOOD PICKET)

TEMPORARY CONSTRUCTION FENCE

total 34

- (D) POTENTIAL GRAVE AS INDICATED BY DEPRESSION IN GROUND SURFACE
- (R) POTENTIAL GRAVE AS INDICATED BY (GROUND PENETRATING RADAR)
- (M) GRAVE STONE
- (A) METAL GRAVE MARKER
- (V) SHALLOW DFNSE OBJECT AS INDICA
- (W) METAL AS INDICATED BY GPR
- (*) GPR TRANSECT TEST POINTS
- (*) TREE

left out for 100

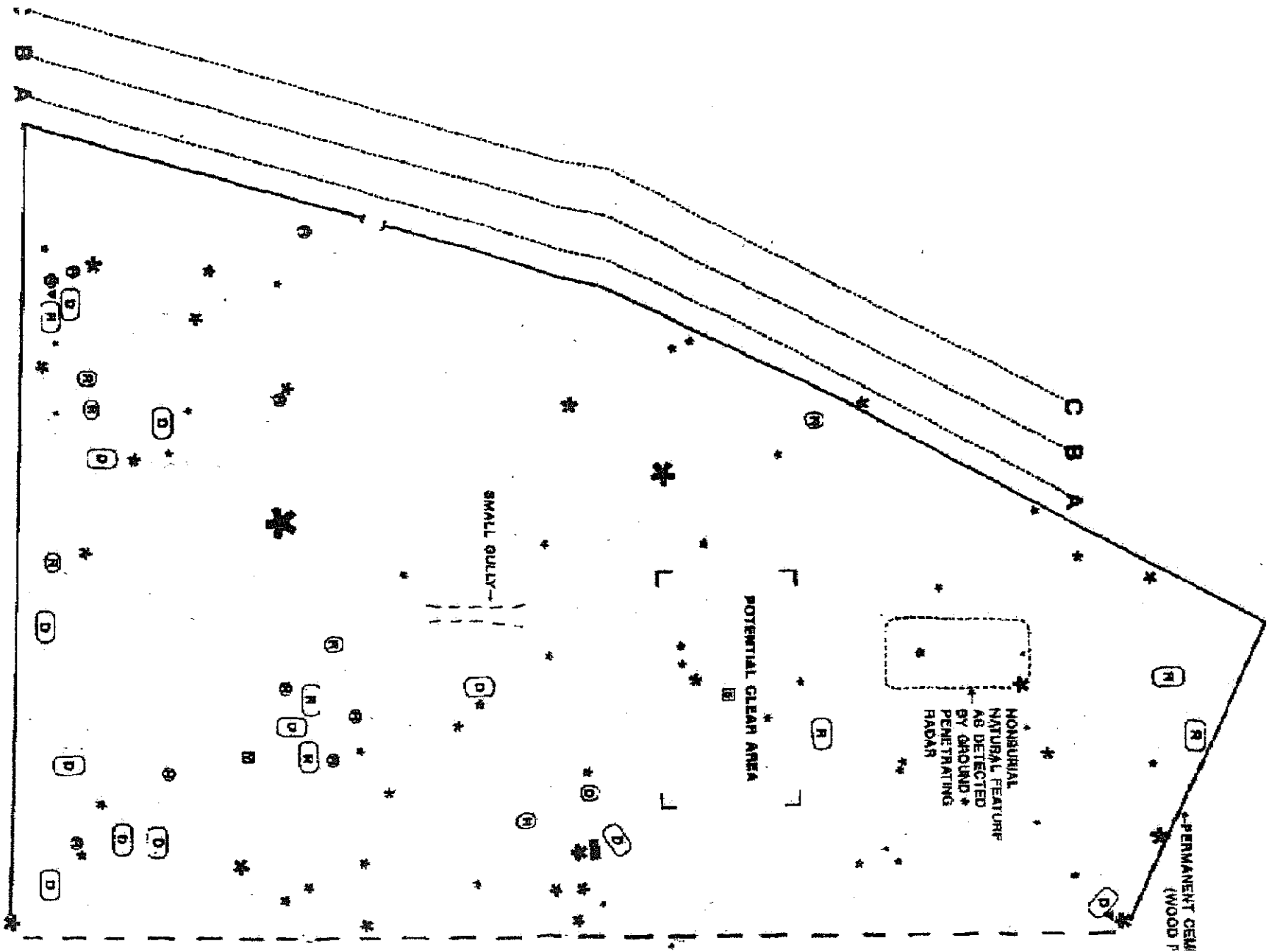

SITE #164-25
Frogg Rd. Cemetery
Windsor, CT

*previously
discarded
burials*



SCALE
 5 METERS

- (D)** POTENTIAL GRAVE / DEPRESSION IN GROUND
- (R)** POTENTIAL GRAVE / (GROUND PENETRATING RADAR)
- (M)** GRAVE STONE
- ▲** METAL GRAVE MARK
- SHALLOW DENSE OBJECT
- METAL AS INDICATED
- A** CIPR TRANSECT TREE

child/infant